

TOP VIEW

INLET TYPE	W	W ₁	X
G-1	2'-8 7/8"	1'-8 7/8"	10 9/16"
G-2	3'-3 3/8"	2' 3 3/8"	16 9/16"

NOTES:

1. CONCRETE STRENGTH SHALL BE 3000 PSI.
2. PRECAST BASE WALLS SHALL BE A MINIMUM 4" THICK. CAST-IN-PLACE BASE WALLS SHALL BE 6" THICK.
3. "X" DIMENSION ASSUMES A 24" GUTTER. ADD 6" FOR AN 18" GUTTER.

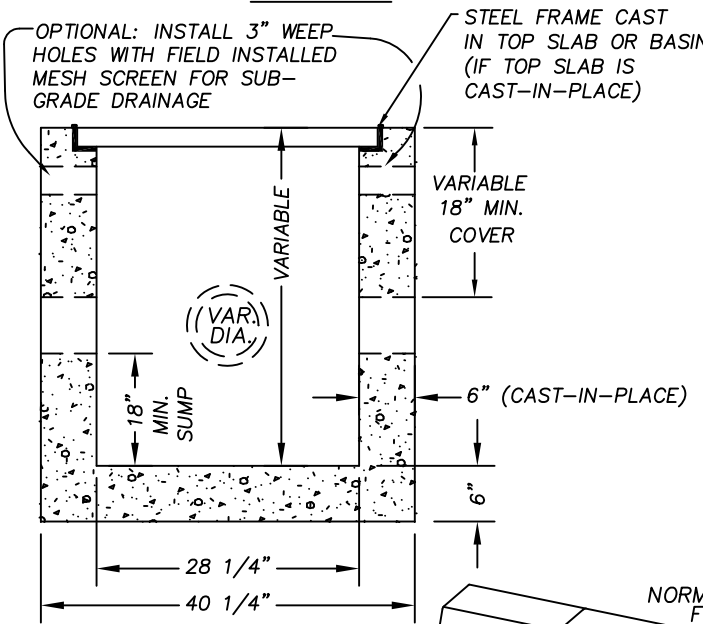

SECTION A-A

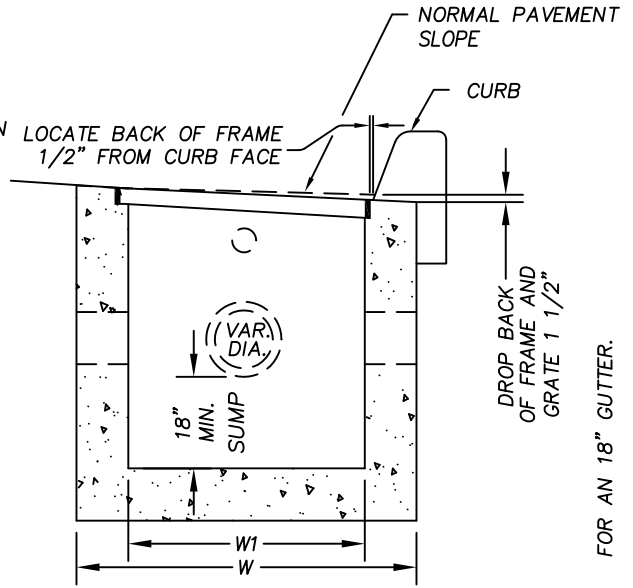

SECTION B-B

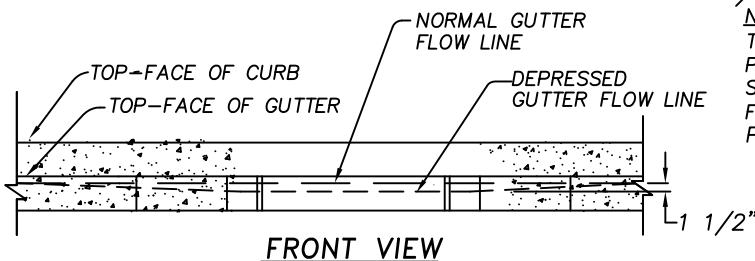
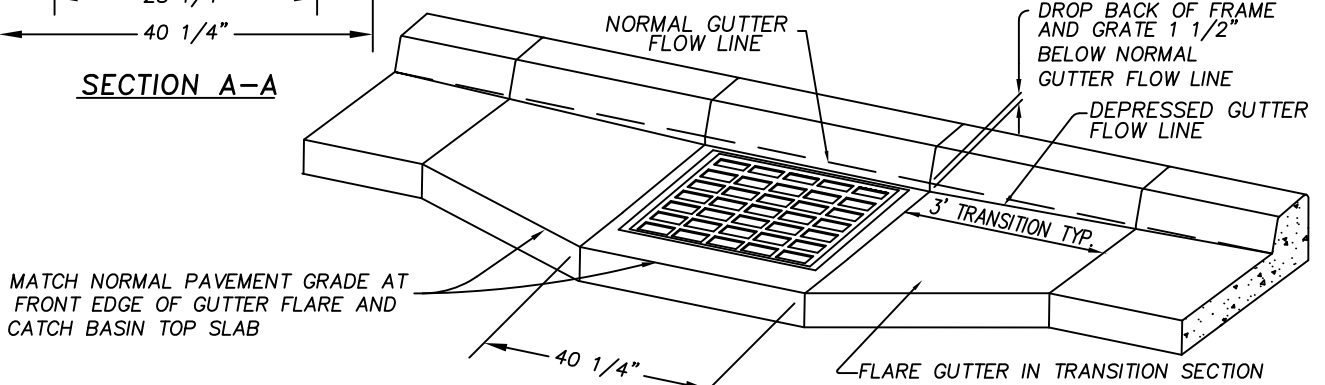

FRONT VIEW

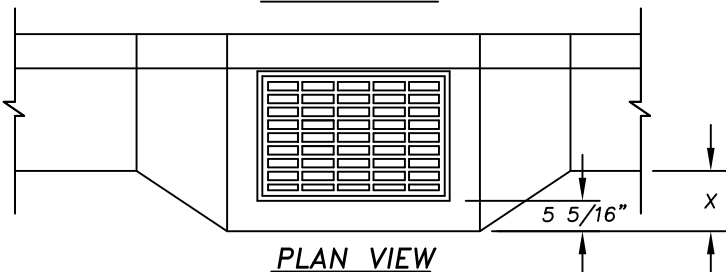

PLAN VIEW

NOTE: PRECAST TOP SLAB SHOWN WITH GUTTER TRANSITION FLARE IF THE TOP SLAB IS CAST-IN-PLACE, NO FLARE IS REQUIRED IN THE TRANSITION SECTION: MATCH THE TOP FRONT EDGE OF THE FRAME AND THE TOP FRONT EDGE OF THE CAST-IN-PLACE TOP SLAB TO THE NORMAL PAVEMENT GRADE.

**CITY OF FLORENCE
STANDARD DRAWING**

**TYPE G-1,
G-2 CATCH BASIN
WITH SUMP**

DATE:
MARCH 2007

DRAWING NO.
F-305c