

VEGETATION DETAIL
 OPEN SPACE (B)

NOTE: NATIVE TO REMAIN:
 SALAL, PACIFIC WAXMYRTLE,
 EVERGREEN HICKLEBERRY,
 PACIFIC RHODODENDRON
 TEMPORARY IRRIGATION/DRIP
 INSTALLED TO NEW TREES

SPECIFICATIONS (B)

- BENCH INSTALLED SOUTH END
- WALKING PATH INSTALLED RUNNING NORTH/SOUTH, WOOD CHIPS ON LANDSCAPE FABRIC
- DOGGY BAG STATION (C)

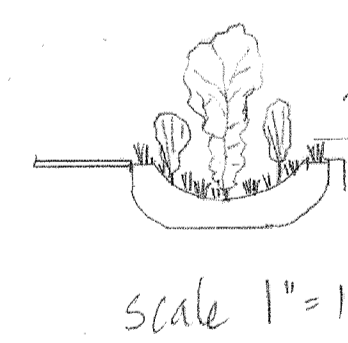
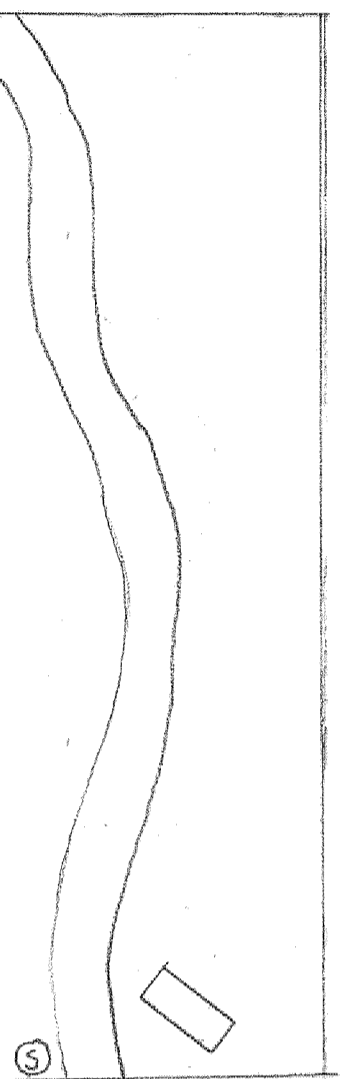

PLANTING DETAIL: TYPICAL PUBLIC VEGETATED SWALE (1A, 1B, 1C, 1D, 1E, 1F, 1G, 1H)

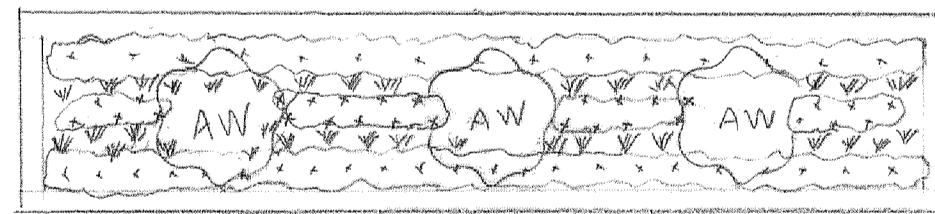

- SHRUBS: SPIRAEA DOUGLASSII DOUGLAS SPIREA } PLANTING 3-5' OC
 CORNUS SERICEA RED TWIG DOGWOOD }
 SALIX PURPUREA ARTIC BLUE WILLOW }
 HERBACEOUS: CAREX OBNUPTA SLOUGH SEDGE } PLANTING 18" OC
 JUNCUS EFFUSUS COMMON RUSH }
 JUNCUS PATENS SPREADING RUSH }
 DECORATISSIMA (ESPHUSA) TUFTED HAIRGRASS }

3D PLANTING DETAIL



- SHRUBS: SPIRAEA DOUGLASSII DOUGLAS SPIREA } PLANTING 3' OC
 HERBACEOUS: CAREX OBNUPTA SLOUGH SEDGE } PLANTING 18" OC
 JUNCUS PATENS SPREADING RUSH }

VEGETATION DETAIL
 OPEN SPACE (A)

scale 1" = 10'

- NATIVE UPLAND GRASS AREA
 - COASTAL PACIFIC NW GRASS SPECIES
 MOWED AS NEEDED FOR RECREATIONAL USE
- NATIVE UPLAND GRASS AREA
 - COASTAL PACIFIC NW GRASS SPECIES NOT MOWED; LEFT FOR POLLINATOR HABITAT
- NATIVE VEGETATION MAT LEFT TO REGROW AS WILDLIFE/POLLINATOR HABITAT AREA. NOXIOUS WEEDS REMOVED AS NEEDED.

SPECIFICATIONS (A)

- GRASS AREAS PREPARED WITH MINIMUM FOUR INCHES TOPSOIL AND COMPOST, SEEDS AT RECOMMENDED RATE. FERTILIZED YEARLY
- ALL GRASS AREAS IRRIGATED
- GAZEBO - WOOD & METAL, 10' x 12', GRAVEL INSTALLED AROUND PERIMETER
- BENCH LOCATED AT ENTRY
- DOGGY BAG STATION (C)
- WOOD CHIP PATH TO GAZEBO, INSTALLED ON LANDSCAPE FABRIC

