

ATTACHMENT 1

Tentative Plan

Myrtle Glenn Subdivision
Preliminary PUD Application to City of Florence
December 2, 2022
Attachment Revised/Resubmitted February 21, 2023





| | |
|--------------|--------------|
| Checked by | BWC |
| Design by | BWC |
| Job Number | 7091-21-0067 |
| Date | 1-8-2023 |
| Sheet Number | SHEET 3 |

ECR & Associates, Inc.
 Engineers, Geologists, and Surveyors
 2535B North Road
 Eugene, Oregon 97402
 Fax (541) 688-0122
 (541) 688-0122

TENTATIVE ACCESS AND PARKING PLAN
 FOR
 MYRTLE GLENN PUD
 NE 1/4, SECTION 22, TOWNSHIP 18 SOUTH, RANGE 12 WEST
 OF THE WILLAMETTE MERIDIAN, LANE COUNTY, OREGON
 AUGUST 16, 2022

PARKING ANALYSIS
 PER TABLE NEXT TO SINGLE-FAMILY ATTACHED DWELLINGS REQUIRES 2 SPACES PER UNIT. THIS PROJECT REQUIRES 25 SPACES PER UNIT. THE MINIMUM REQUIREMENTS IS PARKING IN GARAGES, IN DRIVEWAYS PER ICC, IN-SHARED AND SHARED PARKING.
 NUMBER OF ATTACHED DWELLINGS = 25
 NUMBER GARAGES = 25
 NUMBER DRIVEWAYS = 25
 NUMBER SHARED PARKING = 13
 TOTAL NUMBER PARKING PROVIDED = 63

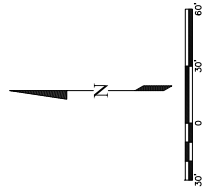
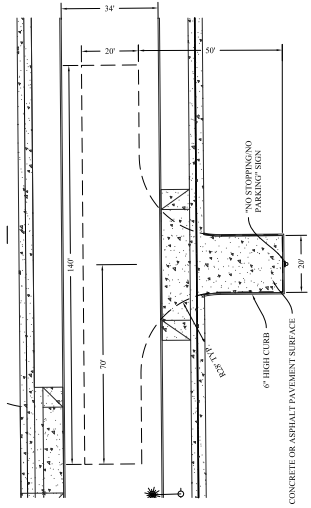
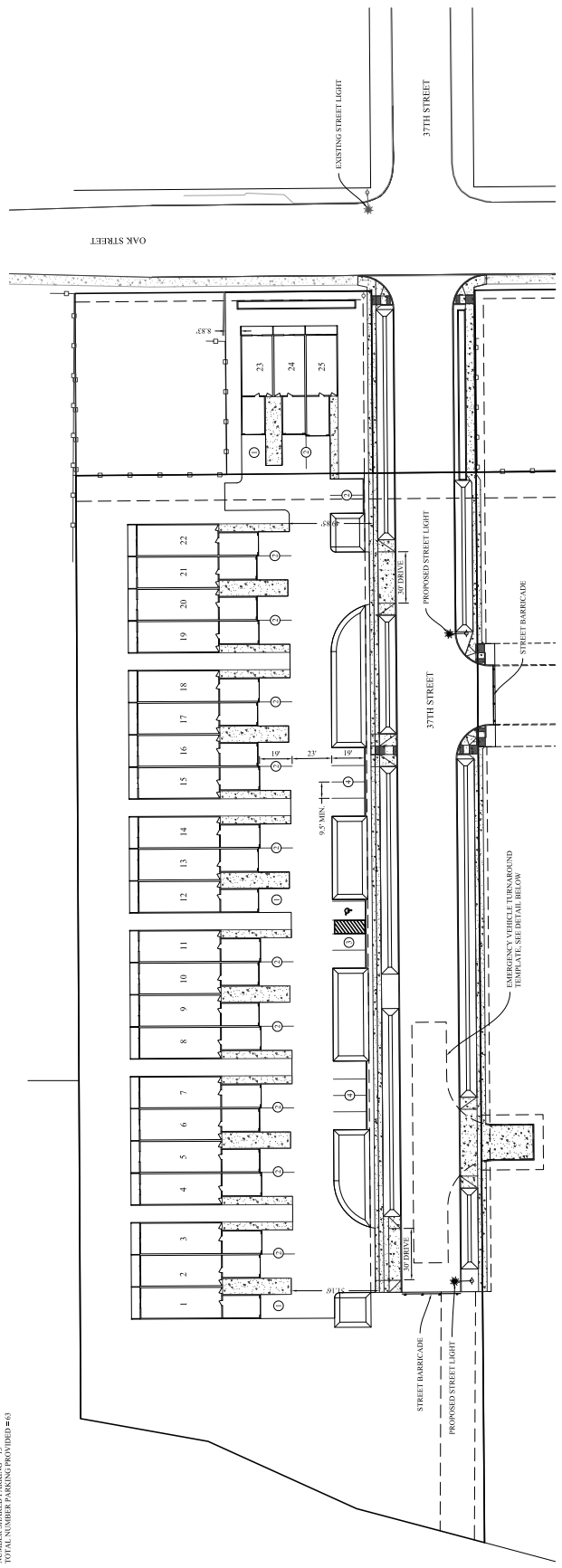

PRELIMINARY - NOT FOR CONSTRUCTION



| Date | Description of Revisions | Date | Name |
|------|--------------------------|------|------|
| | | | |
| | | | |
| | | | |
| | | | |

| | |
|------------|-----------------|
| Date | 1-6-2023 |
| Job Number | 70912-10087 |
| Drawn by | CLINT BEECHCOTT |
| Checked by | CLINT BEECHCOTT |

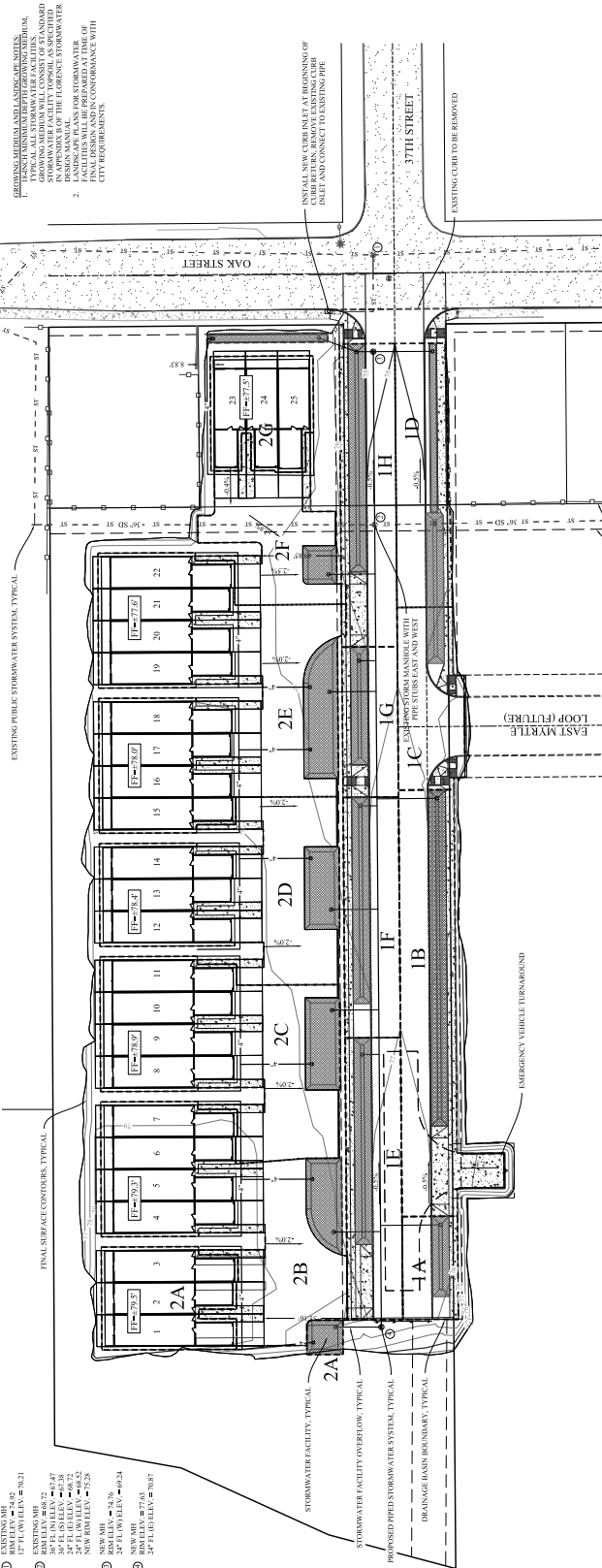
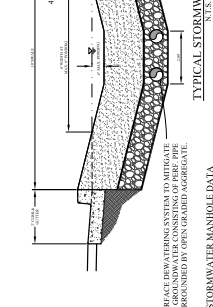
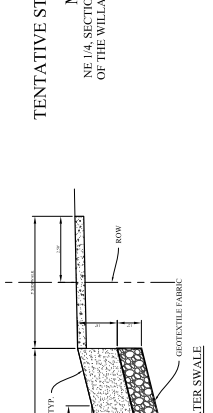
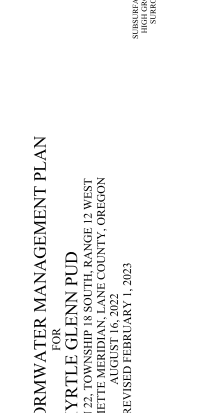
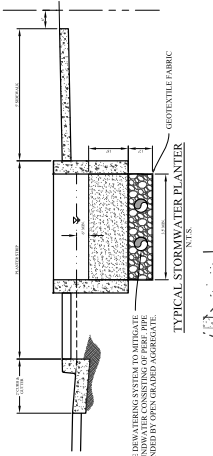

FINAL DESIGN NOTE:
THIS STORMWATER MANAGEMENT PLAN IS TENTATIVE. FINAL FACILITY SIZES, PIPE SIZES, CONNECTION DETAILS TO THE PUBLIC STORMWATER MAINLINE IN THE STREET, AND SWALE STYLES SHALL BE DETERMINED BY THE CITY OF FLORENCE. APPROVALS WILL BE OBTAINED PRIOR TO CONSTRUCTION.

STORMWATER FACILITY DESIGN NOTES

- FACILITIES ARE SIZED PER THE FLORENCE STORMWATER MANUAL. PRESUMPTIVE APPROACH IS TYPE 1 (A-K) ALL DISTRIBUTION, THE UNIT HYDROGRAPH METHOD, 2-HOUR STORAGE TIMES, AND DESTINATION IS THE LOCAL FACILITY STANDARDS.
- PIPE FLORENCE STORMWATER MANUAL. A 15-MINUTE QUALITY DESIGN RAINFALL DEPTH OF 0.8 INCHES SHALL BE USED FOR DESIGN. THE DESIGN RAINFALL DEPTH SHALL BE USED FOR DESIGN. THE FLORENCE STORMWATER MANUAL LIMITS THE DESIGN INLET FLOW RATE TO 100 GPM PER HOUR. THE RESULTING FACILITY SIZES AND DEPTHS WERE DESIGNED TO STORE A 25-YEAR PROPOSED LOCAL STORMWATER PIPE IN 1511 SYSTEM (PIPE DIAMETERS 12 INCHES AND 18 INCHES) AND AN EXISTING POINT DRAINER PUBLIC STORM DRAIN PIPE LOCATED ON A BRANCH OF THE INTERSECTION OF 37TH AND LAURELWOOD STREETS, SOUTH LAURELWOOD STREET WEST TO THE BUNKAWYR. SWALE WITH A CONVEYANCE THAT FLOWS SOUTHWEST AND WEST TO THE BUNKAWYR.
- FINAL DESIGN SHALL BE OBTAINED PRIOR TO CONSTRUCTION.
- EXISTING UTILITY LOCATIONS SHALL BE MAINTAINED AND PROTECTED.
- EXISTING UTILITY LOCATIONS SHALL BE MAINTAINED AND PROTECTED.
- EXISTING UTILITY LOCATIONS SHALL BE MAINTAINED AND PROTECTED.

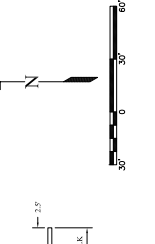

TABLE 1. STORMWATER FACILITY SIZING

| Basin ID | Facility Type | Facility Supps | Basin Area, S.F. | Facility Width | Facility Length | Max. Inlet Depth |
|----------|---------------|----------------|------------------|----------------|-----------------|------------------|
| 1A | BS | 4-1 | 1,959 | 100' | 47.0' | 0" |
| 1B | BS | 4-1 | 6,672 | 100' | 193.0' | 0" |
| 1C | BS | 4-1 | 3,880 | 100' | 86.0' | 0" |
| 1D | BS | 4-1 | 5,526 | 100' | 133.0' | 0" |
| 1E | BS | 4-1 | 4,574 | 100' | 120.0' | 0" |
| 1F | BS | 4-1 | 2,858 | 100' | 113.0' | 0" |
| 1G | BS | 4-1 | 5,795 | 100' | 113.0' | 0" |
| 1H | BS | 4-1 | 6,672 | 100' | 193.0' | 0" |
| 2A | BP | 3-1 | 1,624 | 21.0' | 26.2' | 12" |
| 2B | BP | 3-1 | 1,253 | 21.0' | 20.2' | 12" |
| 2C | BP | 3-1 | 1,226 | 20.7' | 24.6' | 12" |
| 2D | BP | 3-1 | 1,172 | 20.5' | 20.6' | 12" |
| 2E | BP | 3-1 | 1,902 | 20.1' | 25.7' | 12" |
| 2F | BP | 3-1 | 5,145 | 19.9' | 22.4' | 12" |
| 2G | BP | 3-1 | 4,175 | 4.0' | 66.0' | 12" |

1A-1H = PUBLIC BASIN (D) STORMWATER FACILITIES
2A-2F = PRIVATE BASIN (D) STORMWATER FACILITIES
2G-2H = INFILTRATION SWALE
2I-2J = INFILTRATION BASIN

PRELIMINARY - NOT FOR CONSTRUCTION