



Oregon

John A. Kitzhaber, MD, Governor

Department of State Lands

775 Summer Street NE, Suite 100

Salem, OR 97301-1279

(503) 986-5200

FAX (503) 378-4844

www.oregonstatelands.us

December 27, 2011

City of Florence

Attn: Mike Miller, Florence Public Works Director

250 Highway 101 North

Florence, Oregon 97439

State Land Board

John A. Kitzhaber, MD

Governor

Re: Wetland Delineation Report for Florence, Lane County;
T18S R12W Sec. 34, Tax Lot (not numbered, below Hwy
101 bridge) and Part of Tax Lot 90000; WD #2011-0310

Kate Brown

Secretary of State

Ted Wheeler

State Treasurer

Dear Mr. Miller:

The Department of State Lands has reviewed the wetland delineation report prepared by PBS Engineering and Environmental for the site referenced above. Please note that the study area is mostly within an unnumbered tax lot and part of a numbered tax lot as described above (please see the attached map). Based upon the information presented in the report and additional information submitted upon request, we concur with the wetland and waterway boundaries as mapped in Figure 5 of the report. Please replace all copies of the preliminary wetland map with this final Department-approved map. Within the study area, the Siuslaw River estuary, 0.038 acres of wetlands, and an undetermined area of estuarine habitat were identified. The estuary and the associated wetlands/estuarine habitat are subject to the permit requirements of the state Removal-Fill Law. The Siuslaw River estuary and all hydrologically-connected wetlands are designated essential salmonid habitat; therefore, fill or removal of any amount of material within the wetland or within Highest Measured Tide (HMT) may require a state permit. The elevation of HMT along the Siuslaw River estuary in Florence is 10.5 feet above MLLW (10.4 feet above NAVD88 or 6.94 feet above NGVD29).

This area of Siuslaw River is a state-owned waterway; any activity encroaching within the submerged and submersible land below the line of ordinary high water may require a lease, registration, or easement to occupy state-owned land. Please contact Jim Grimes at 503-986-5233 for more information.

This concurrence is for purposes of the state Removal-Fill Law only. Federal or local permit requirements may apply as well. The Army Corps of Engineers will review the report and make a determination of jurisdiction for purposes of the Clean Water Act at the time that a permit application is submitted. We recommend that you attach a copy of this concurrence letter to both copies of any subsequent joint permit application to speed application review.

Please be advised that state law establishes a preference for avoidance of wetland impacts. Because measures to avoid and minimize wetland impacts may include reconfiguring parcel layout and size or development design, we recommend that you work with Department staff on appropriate site design before completing the city or county land use approval process.

This concurrence is based on information provided to the agency. Because of the age of the submitted report, the jurisdictional determination is valid for one year from the date of this letter, unless new information necessitates a revision. Circumstances under which the Department may change a determination are found in OAR 141-090-0045 (available on our web site or upon request). In addition, laws enacted by the legislature and/or rules adopted by the Department may result in a change in jurisdiction; individuals and applicants are subject to the regulations that are in effect at the time of the removal-fill activity, or complete permit application. The applicant, landowner, or agent may submit a request for reconsideration of this determination in writing within six months of the date of this letter.

Thank you for having the site evaluated. Please phone me at 503-986-5297 if you have any questions.

Sincerely,

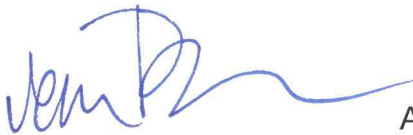

Jevra Brown
Wetland Specialist

Approved by

Anna Buckley
Acting Wetlands Program Manager

Enclosures

ec: Skip Haak, PBS Engineering and Environmental
City of Florence Planning Department (Maps enclosed for updating LWI)
Brian Wilson, Corps of Engineers, Eugene office
Gloria Kiryuta, DSL

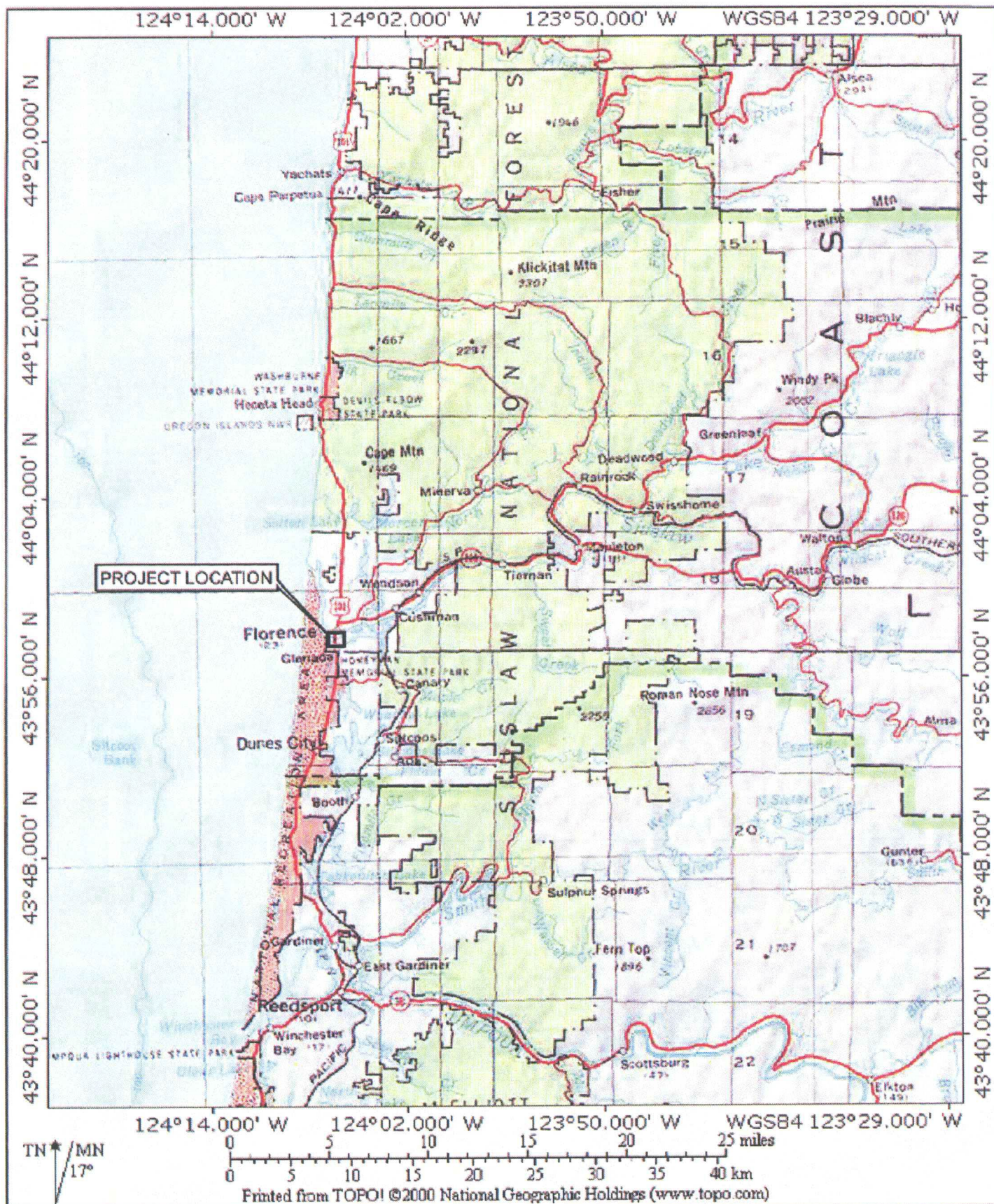

Project #
75032.000

Date:
AUGUST 2007

PROJECT LOCATION
Siuslaw River Bridge Interpretive Wayside
Florence, Oregon

DSL
WD 2011-0310

FIGURE
1

L:\WACO\COVER\General\Chilod\Don_James\75032.dwg\75032.000_SIU.SLAW_RIVER_FIG-5.dwg Sep 10, 2007 05:04pm dcm

DSL WD # 2011-0310

Approval Issued 12/27/2011

Approval Expires 12/27/2012

0' 15' 30' 60'
SCALE: 1" = 40'



STUDY AREA

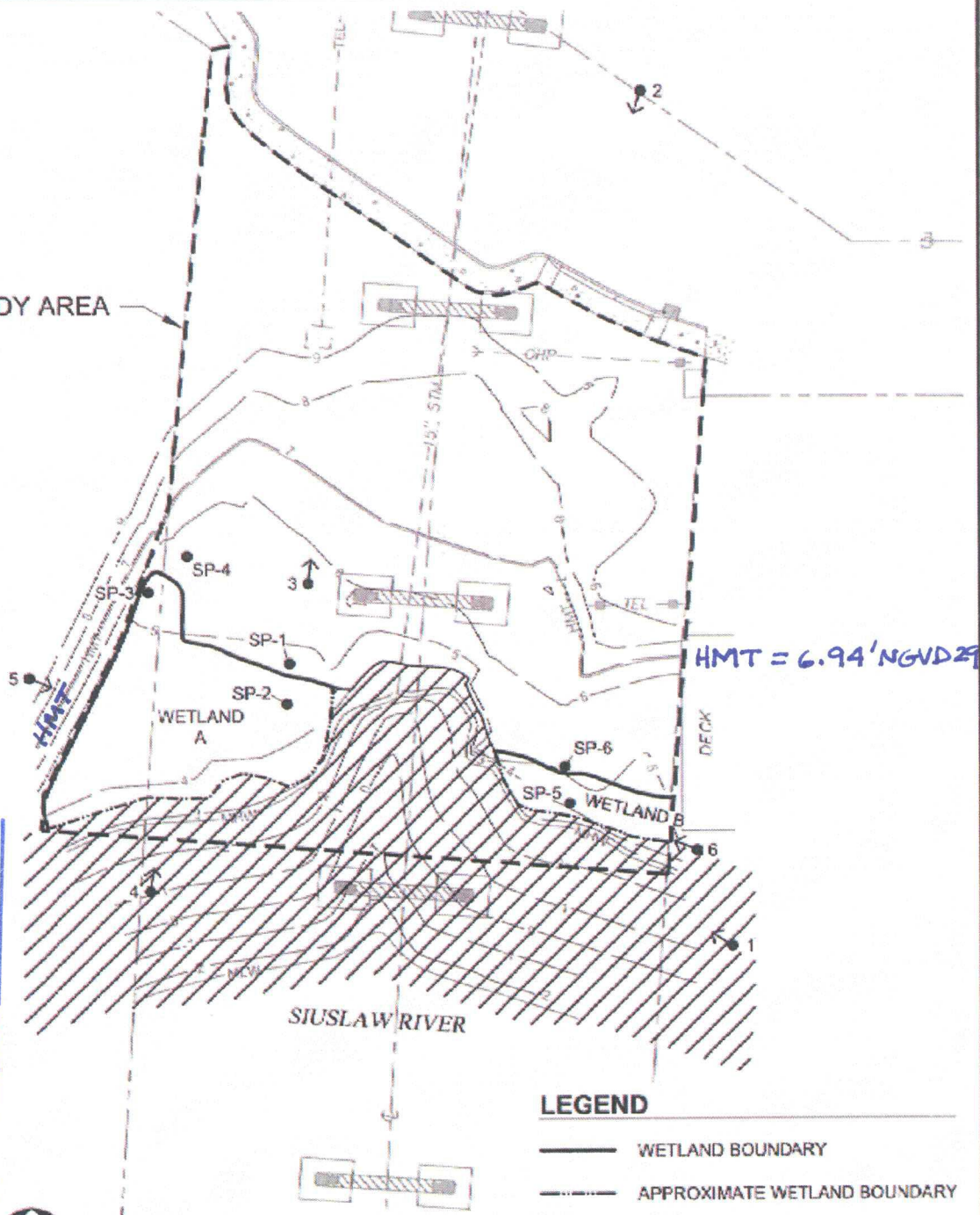

LEGEND

- WETLAND BOUNDARY
- - - - - APPROXIMATE WETLAND BOUNDARY
- INTERTIDAL MUDFLAT
- SP-1 ● DATA PLOT
- ➔ 1 PHOTO POINT

PREPARED FOR: BRANCH ENGINEERING



PROJECT #:
75032.000
DATE:
SEPT. 2007

WETLAND DELINEATION MAP
SIUSLAW RIVER BRIDGE INTERPRETIVE WAYSIDE
FLORENCE, OREGON

FIGURE
5

WETLAND DELINEATION / DETERMINATION REPORT COVER FORM

This form must be included with any wetland delineation report submitted to the Department of State Lands for review and approval. A wetland delineation report submittal is not "complete" unless the fully completed and signed report cover form and the required fee are submitted. Attach the form to the front of an unbound report and submit to: **Oregon Department of State Lands, 775 Summer Street NE, Suite 100, Salem, OR 97301-1279**

Mail a copy of the completed form with payment of the required report review fee to: **Oregon Department of State Lands, P.O. Box 4395, Unit 18, Portland, OR 97208-4395.**

For new credit card payment option, see DSL web site.

DEPARTMENT OF STATE LANDS

SEP 28 2011

RECEIVED

<input checked="" type="checkbox"/> Applicant <input type="checkbox"/> Owner Name, Firm and Address: Mike Miller, Florence Public Works Director Florence, OR 97439 <u>City Hall, 250 Hwy 101 N.</u>	Business phone # (541) 997-4106 Mobile phone # (optional) FAX # E-mail: <u>mike.miller@ci.florence.or.us</u>
<input checked="" type="checkbox"/> Authorized Legal Agent, Name and Address: Chris Irvin PE BRANCH ENGINEERING 310 Fifth Street, Springfield OR 97477	Business phone # 541-746-0637 FAX # Mobile phone # E-mail: <u>chris@branchengineering.com</u>

I either own the property described below or I have legal authority to allow access to the property. I authorize the Department to access the property for the purpose of confirming the information in the report, after prior notification to the primary contact.

Typed/Printed Name: Chris Irvin P.E. Signature: [Signature]

Date: _____ Special instructions regarding site access: _____

Project and Site Information (for latitude & longitude, use centroid of site or start & end points of linear project)

Project Name: Siuslaw River Bridge Interpretive Wayside	Latitude: 43 57' 57.04" <u>43.965844</u>	Longitude: 124 06' 28.64 <u>-124.107955</u>
Proposed Use: Parking and interpretive wayside	Tax Map # 18123414	
Project Street Address (or other descriptive location): Highway 101 ROW immediately south of Bay Street in Florence	Township 18S Range 12W Section 34 QQ Tax Lot (s) n/a	
City: Florence County: Lane	Waterway: Siuslaw River Mile: 4.3 NWI Quad(s): Florence	

Wetland Delineation Information

Wetland Consultant Name, Firm and Address: PBS Engineering + Environmental	Phone # 5416868484 Mobile phone # FAX # 5416864602 E-mail: <u>Skip_Haak@pbsenv.com</u>
The information and conclusions on this form and in the attached report are true and correct to the best of my knowledge.	
Consultant Signature: <u>[Signature]</u>	Date: <u>9/21/11</u>
Primary Contact for report review and site access is <input type="checkbox"/> Consultant <input type="checkbox"/> Applicant/Owner <input checked="" type="checkbox"/> Authorized Agent	
Wetland/Waters Present? <input checked="" type="checkbox"/> Yes <input type="checkbox"/> No	Study Area size: 10,300 sf Total Wetland Acreage: 1,120 sf

Check Box Below if Applicable:

Fees:

<input type="checkbox"/> R-F permit application submitted <input type="checkbox"/> Mitigation bank site <input type="checkbox"/> Wetland restoration/enhancement project (not mitigation) <input type="checkbox"/> Industrial Land Certification Program Site	<input checked="" type="checkbox"/> Fee payment submitted \$ 369.00 <input type="checkbox"/> Fee (\$100) for resubmittal of rejected report Name of Payor: Branch Engineering
Other Information:	
Has previous delineation/application been made on parcel?	Y <input type="checkbox"/> N <input checked="" type="checkbox"/> If known, previous DSL #
Does LWI, if any, show wetland or waters on parcel?	<input checked="" type="checkbox"/> <input type="checkbox"/>

For Office Use Only

AAB

DSL Reviewer: <u>JB</u>	Fee Paid Date: <u>9 / 28 / 11</u>	DSL WD # <u>2011-0310</u>
Date Delineation Received: <u>9 / 23 / 11</u>	DSL Project # _____	DSL Site # _____
Scanned: <input checked="" type="checkbox"/> Final Scan: <input type="checkbox"/>	DSL WN # _____	DSL App. # _____

