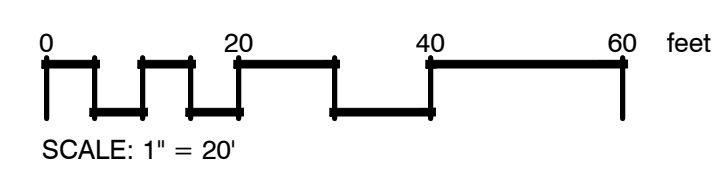
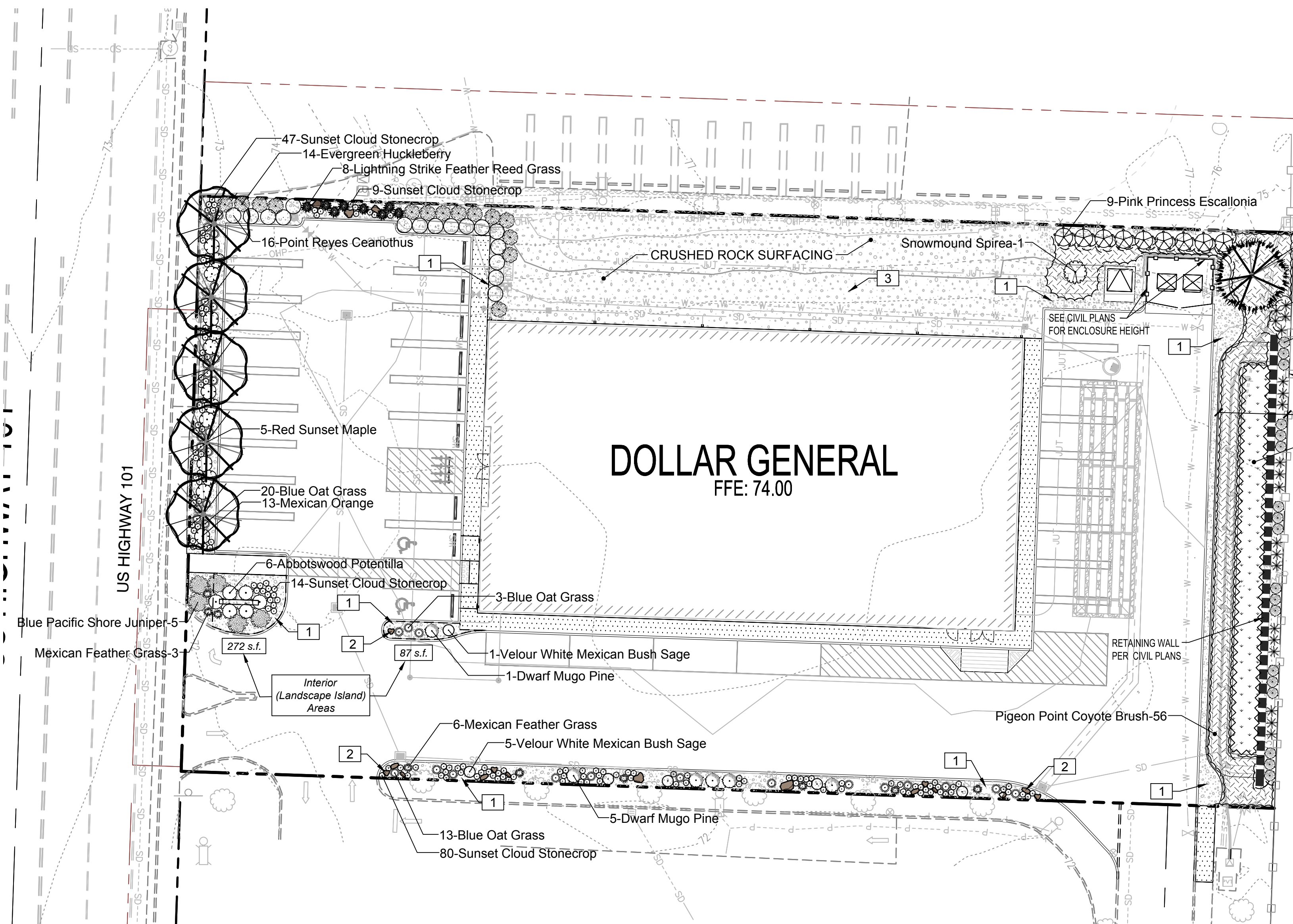

Exhibit E



LANDSCAPE CODE - CALCULATIONS

Landscape Island Requirement		Total Lot Area	43,418 s.f.
10 s.f. / parking stall		Required Landscape Area (15% of lot area)	6,513 s.f.
Number of parking stalls	32	Landscape Area Provided	10,278 s.f.
Required Landscape Island Area	320 s.f.	Required Landscape Area	6,513 s.f.
Landscape Island Area Provided	359 s.f.	Required "Living plant material" coverage (70%)	4,559 s.f.
		"Living plant material" coverage provided	4,607 s.f.

Landscape Area Calculations		NOTE: ALL PLANTINGS SHALL BE IRRIGATED BY A PERMANENT UNDERGROUND IRRIGATION SYSTEM. DESIGN TO FOLLOW IN SUBSEQUENT SUBMITTAL.	
Lawn Area	0 s.f. (0%)		
Shrub Bed Area	4,607 s.f. (100%)		
Trees (Qty.)	6 trees		
Total Landscape Area	4,607 s.f. (100%)		

Street Frontage Requirements	
Street Frontage	151 l.f.
Street Trees Required (1/30 l.f. of frontage)	5 trees
Street Trees Provided	5 trees
Shrubs Required (6/30 l.f.)	30 shrubs
Shrubs Provided	43 shrubs

REFERENCE NOTES SCHEDULE

SYMBOL	DESCRIPTION
	1 DECORATIVE ROCK MULCH
	2 LANDSCAPE BOULDER
	3 CRUSHED ROCK SURFACING. 4" DEPTH COMPACTED 5/8" MINUS

PLANT SCHEDULE

TREES	QTY	COMMON / BOTANICAL NAME	SIZE	
	5	RED SUNSET MAPLE ACER RUBRUM 'FRANKSRED'	1.75" CAL. B&B/CONT	
	1	AUSTRIAN PINE PINUS NIGRA	5' MIN. HT., B&B/CONT.	
SHRUBS	QTY	COMMON / BOTANICAL NAME	SIZE	SPACING
	16	POINT REYES CEANOTHUS CEANOTHUS GLORIOSUS	1 GAL	48" o.c.
	13	MEXICAN ORANGE CHOISYA TERNATA	3 GAL	48" o.c.
	9	PINK PRINCESS ESCALLONIA ESCALLONIA X EXONIENSIS 'FRADESII'	3 GAL	60" o.c.
	5	BLUE PACIFIC SHORE JUNIPER JUNIPERUS CONFERTA 'BLUE PACIFIC'	3 GAL	60" o.c.
	18	SKYROCKET JUNIPER JUNIPERUS SCOPULORUM 'SKYROCKET'	3 GAL	36" o.c.
	6	DWARF MUGO PINE PINUS MUGO 'PUMILIO'	5 GAL	48" o.c.
	6	ABBOTSWOOD POTENTILLA POTENTILLA FRUTICOSA 'ABBOTSWOOD'	3 GAL	48" o.c.
	6	VELOUR WHITE MEXICAN BUSH SAGE SALVIA LEUCANTHA 'VELOUR WHITE'	1 GAL	36" o.c.
	1	SNOWMOUND SPIREA SPIRAEA NIPPONICA	3 GAL	72" o.c.
	14	EVERGREEN HUCKLEBERRY VACCINIUM OVATUM	3 GAL	48" o.c.
ORNAMENTAL GRASSES	QTY	COMMON / BOTANICAL NAME	SIZE	SPACING
	20	KARL FOERSTER FEATHER REED GRASS CALAMAGROSTIS X ACUTIFLORA 'KARL FOERSTER'	1 GAL	36" o.c.
	8	LIGHTNING STRIKE FEATHER REED GRASS CALAMAGROSTIS X ACUTIFLORA 'LIGHTNING STRIKE'	1 GAL	36" o.c.
	36	BLUE OAT GRASS HELICTOTRICHON SEMPERVIRENS	1 GAL	30" o.c.
	9	MEXICAN FEATHER GRASS NASSELLA TENUISSIMA	1 GAL	30" o.c.
PERENNIALS	QTY	COMMON / BOTANICAL NAME	SIZE	SPACING
	150	SUNSET CLOUD STONECROP SEDUM TELEPHIUM 'SUNSET CLOUD'	6" POT	18" o.c.
SHRUB AREAS	QTY	COMMON / BOTANICAL NAME	CONT	SPACING
	56	PIGEON POINT COYOTE BRUSH BACCHARIS PILULARIS 'PIGEON POINT'	1 GAL	60" o.c.
	635 SF	SLOUGH SEDGE CAREX OBNUPTA	1 GAL	

NOT FOR CONSTRUCTION

BY	
DATE	
REVISIONS	
SCJ ALLIANCE CONSULTING SERVICES	
8730 TALLON LANE, NE, SUITE 200, LACEY, WA 98516	
P: 360.352.1465	
SCJALLIANCE.COM	
LANDSCAPE PLAN - SPR LEVEL	
DOLLAR GENERAL FLORENCE, OREGON	
REGISTERED LANDSCAPE ARCHITECT	
LA 634	
TRENT L. GRANTHAM	
OREGON 07/19/07	
EXP. 07/31/2024	
DESIGNER: A. VOS	
DRAWN BY: A. VOS	
APPROVED BY: J. GLANDER	
DATE: AUGUST 2023	
JOB NO: 23-000186	
DRAWING FILE NO: 22-000186-X-LS	
DRAWING NO: LS-01	
SHEET NO: 1 OF 2	

Aug 15, 2023 10:41:56am User: engrh... C:\DESIGN\WALSH\PROJECTS\2023\22-000186-X-LS.DWG

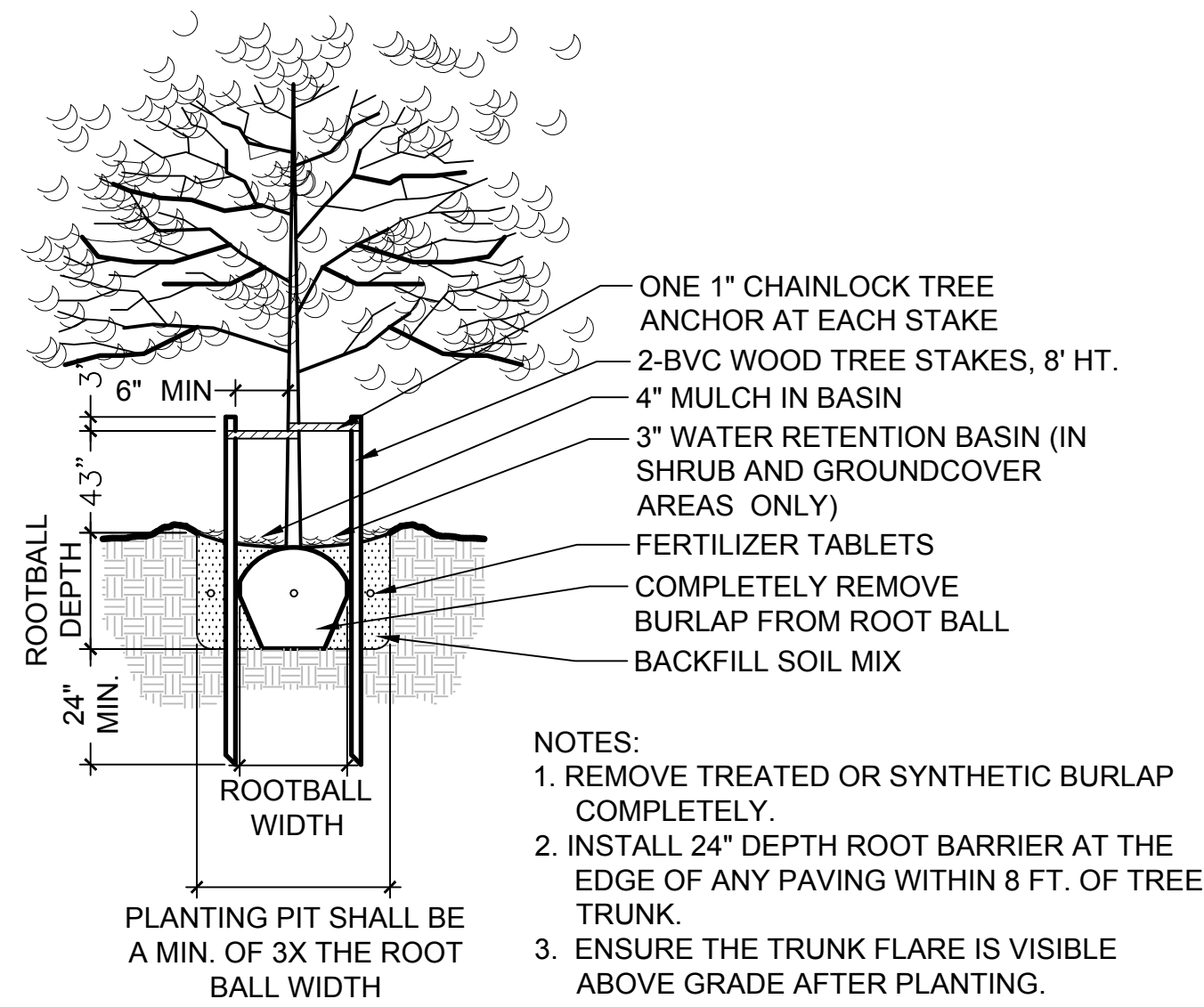

1 TREE PLANTING & STAKING DETAIL
NTS P-CO-DOL14-08

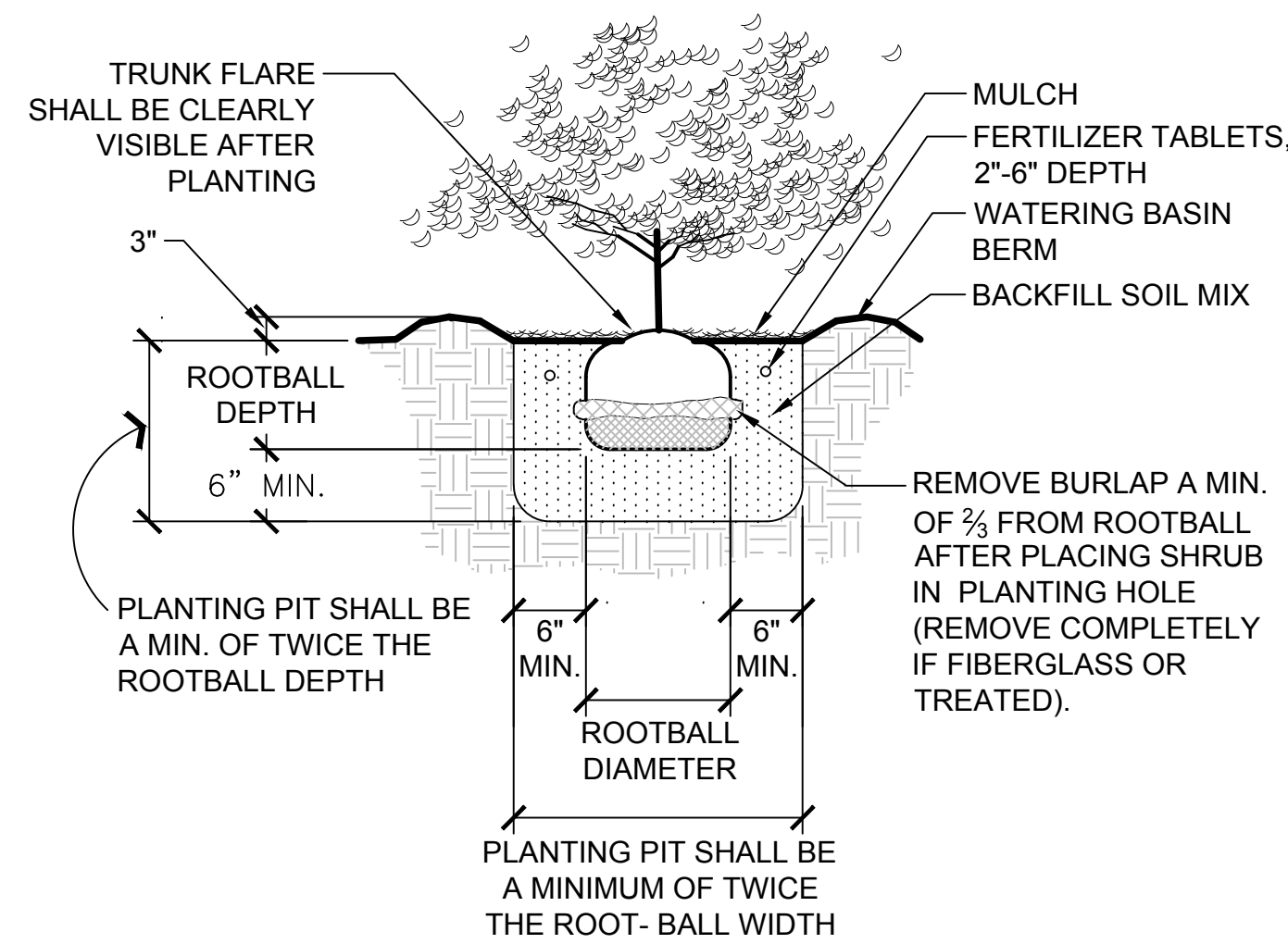

2 SHRUB PLANTING DETAIL (B&B OR CONT.)
NTS P-CO-DOL14-04

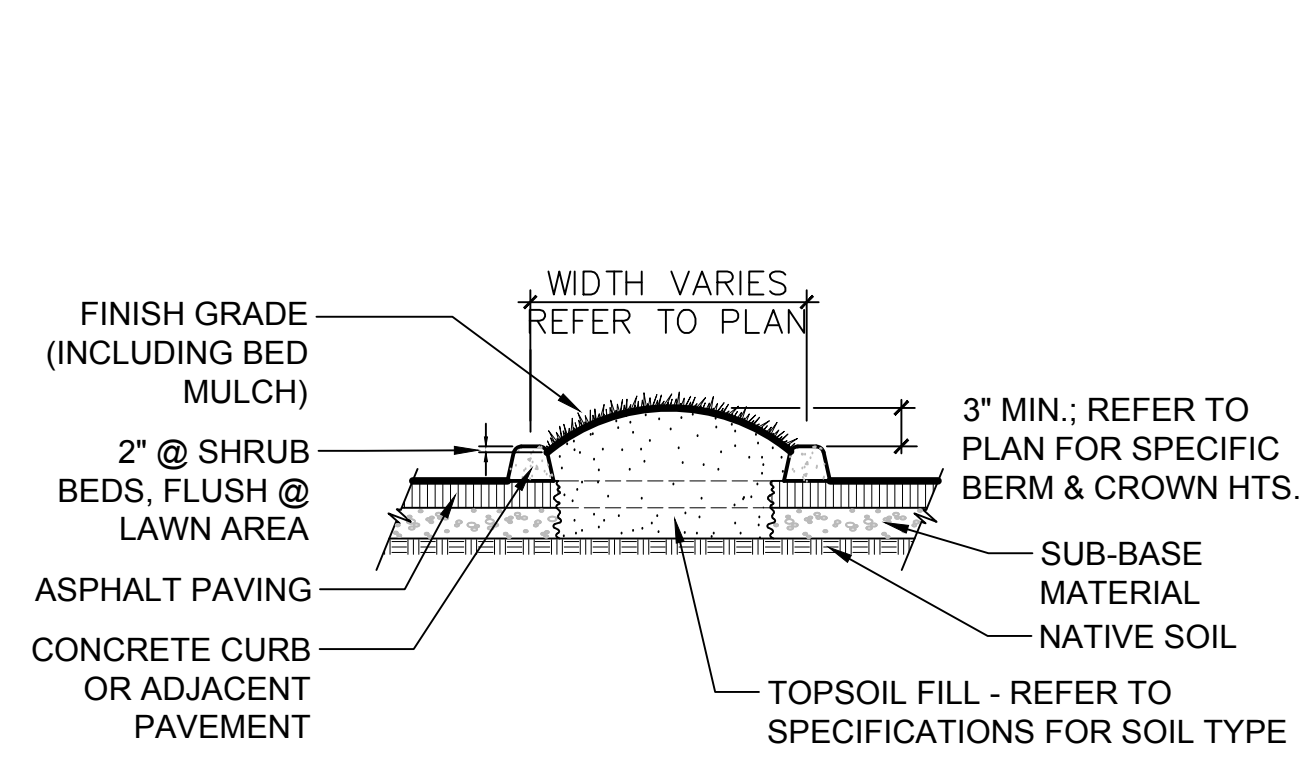

3 PARKING ISLAND PLANTER DETAIL
NTS P-CO-DOL14-02

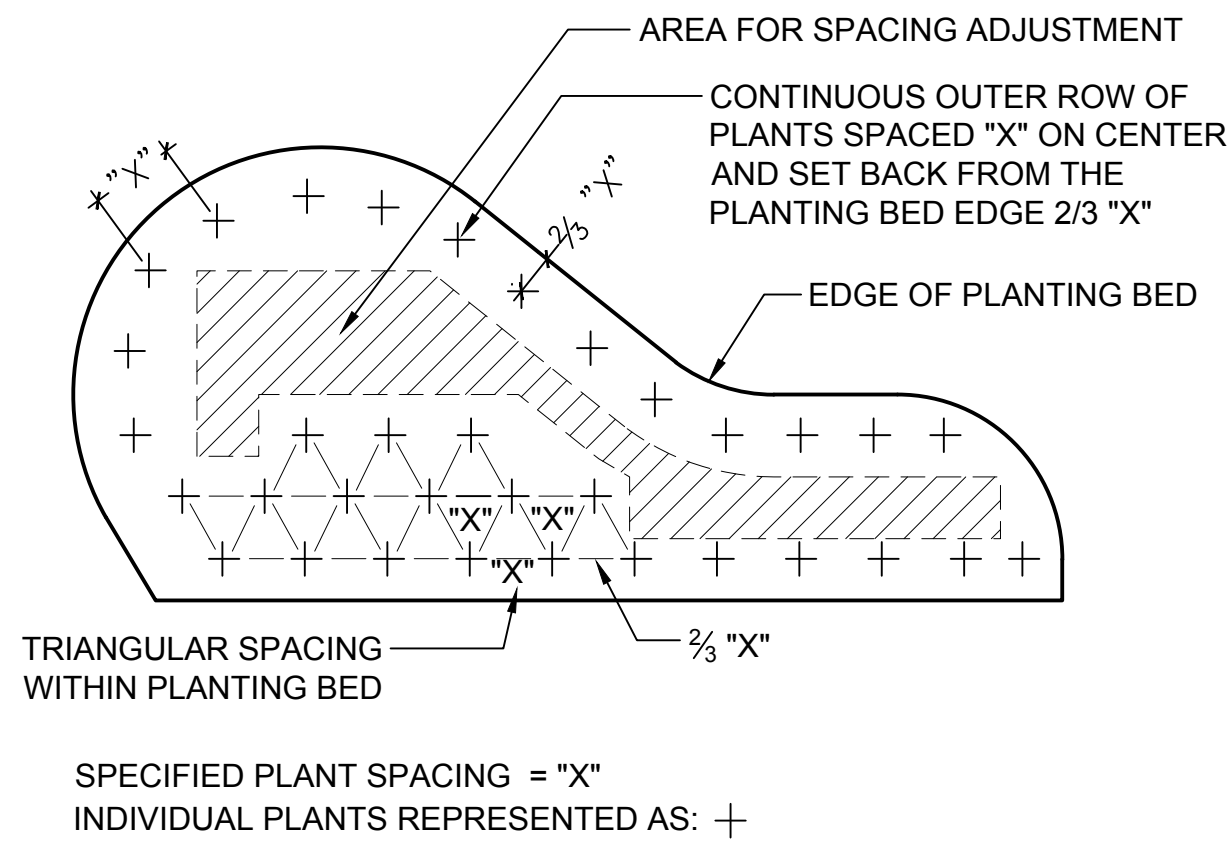

4 PLANT SPACING DETAIL
NTS P-CO-DOL14-01

LANDSCAPE SPECIFICATIONS

- Refer to details for additional information.
- Chemically kill and remove from site all existing weeds and vegetation not shown to remain on plans.
- Distribute imported sandy loam topsoil (approved by the Landscape Architect) in areas shown and at depths indicated for crowning and berming of landscape areas, and backfill of retaining walls (if required). Dotted lines indicate 1' contour intervals. All landscape areas shall receive topsoil, whether indicated on plans or not, so that finish grades of all shrub beds shall be 2" below tops of adjacent curbs and pavement, and lawn areas shall be 1/2" below tops of adjacent curbs and pavement. Structural fill areas: Any landscape areas occurring within structural fill zones shall have said structural fill materials excavated to a depth of 12" below finish grades in shrub areas and 6" below grade in lawn areas, and replaced with specified topsoil. Dispose of excavated material off site.
- Fine grade all landscape beds prior to planting operations.
- No plant substitutions shall be permitted without prior approval of Landscape Architect/Owner.
- All plants shall conform to the latest edition of the American Standard for Nursery Stock.
- All plant materials and plant locations shall be approved by the Landscape Architect prior to installation.
- Root barrier shall be incorporated adjacent and parallel to paving, curb and sidewalk, a minimum of 15 linear feet (7.5' on either side of trunk), 24" deep, where any tree is within 8' of paving, curb or sidewalk. Root barrier shall be DeepRoot UB-24 as available from Ewing Irrigation Products, 2901 S Tacoma Way, Tacoma, WA 98409 (253) 476-9530 or approved equal.
- Soil amendment for soil preparation and planting backfill shall be a screened 5/8" minus nitrified wood residual compost equal to:
 - "Silver Springs Top Grade Compost" brand compost as available from Corliss Resources Lake Tapps, WA (253) 279-9102.
 - "Cedar Grove Compost" brand compost as available from Cedar Grove Compost, Maple Valley, WA (877) 764-5748.
 - PREP/LRI compost as available from Randles Sand and Gravel, Inc., Puyallup, WA (253) 537-6828.
- Soil Preparation - (all landscape areas). Spread 9 c.y. of specified soil amendment per 1000 s.f. (approx. 3" depth) of area. Spread 100 lbs./1000 s.f. of dolomite lime (in lawn areas only), 150 lbs./1000 s.f. of Agricultural Gypsum and 15 lbs./1000 s.f. of 16-8-8 commercial fertilizer over soil amendment. Roto-till all of the above to a 6"-8" depth and grade smooth, compacting as required and removing all rocks, clods and debris.
- Lawn areas (seed or sod refer to plans) shall consist of one of the following turf types:

60% Turf-Type Perennial Rye Grass Varieties	60% Turf-Type Perennial Rye Grass Varieties
20% Bluegrass	40% Turf-Type Fescue
20% Hard Fescue	
- Seed and sod shall be equal to that as grown by Country Green Turf Farms; Olympia, WA or JB Instant Lawn, Redmond, WA. Seed shall be applied at 7 lbs/1000 s.f. and include 10 lbs./1000 s.f. of United Horticulture 15-5-10 fertilizer in all lawn areas.
- All trees in lawn areas shall be planted in a 3' diameter circle of bed mulch.
- Backfill mix for all plants (except Rhododendrons & Azaleas) shall be a blend of 1/3 existing site soil, 1/3 coarse sand, and 1/3 soil amendment specified in No. 9. Backfill mix for Rhododendrons and Azaleas shall consist of 2/3 above specified backfill mix and 1/3 fine grind hem-fir bark mulch.
- Apply Osmocote 18-6-12, 9 month slow release fertilizer over the surface of all plant pits at the following rates:

Trees Over 10' Height	2 Cups	Trees Under 10' Height:	1 Cup
All Shrubs Except 1 Gallons:	1/2 Cup	1 Gallon Plants:	1/4 Cup
Ground Covers:	1/4 Cup		
- Fertilizer tablets for all plants shall be Agriform (20-10-5) 21 gram or 10 gram tablets distributed as follows: All trees: 4-21 gram tablets, all shrubs (except 1 gallons): 3-21 gram tablets, all 1 gallons: 1-21 gram tablet, all 2-1/4" and 4" pot ground covers: 1-10 gram tablet each. Set tablets directly next to rootball.
- All shrub and ground cover beds shall receive a 2" depth (6 c.y. per 1000 s.f.) of "Fine Grind" hem/fir bark mulch as top dressing.
- Apply a granular pre-emergent herbicide to all shrub and groundcover beds at the conclusion of the maintenance period. Do not use Casaron or Norasac Brands.
- All work shall be performed to the satisfaction of the Landscape Architect/Owner.
- All plants shall be guaranteed for one full year from date of project acceptance. All replaced plants shall be re-guaranteed. All replacements shall be made within 21 days of receiving written notice from the Owner. Contractor shall not be responsible for plants dying due to Owner neglect or vandalism, after the maintenance period.
- Plant list quantities are shown for reference only. Contractor is responsible for verifying all quantities in list with actual plan call-outs, and installing plantings per the landscape plan. Groundcover and/or mass shrub quantities shall be adjusted as required for field conditions at the specified spacing.
- Final inspection shall occur at the conclusion of a 60-day maintenance & plant establishment period. Maintenance period shall commence upon completion of all landscape installation activities and shall include the following:
 - Mow lawns once per week.
 - Remove all weeds over 1" in height.
 - Replace dead or unhealthy plants.
 - Ensure proper function of irrigation system.
 - Ensure adequate moisture is delivered to all landscape beds including non-irrigated areas.
 - Fertilize all lawns at conclusion of maintenance and plant establishment period.

SCJ ALLIANCE
CONSULTING SERVICES
8730 TALLON LANE, SUITE 200, LACEY, WA 98516
P: 360.352.1465
SCJALLIANCE.COM

SHEET TITLE: **LANDSCAPE DETAILS & SPECS - SPR LEVEL**
PROJECT NAME: **DOLLAR GENERAL FLORENCE, OREGON**

SEAL: **REGISTERED**
LA 634
TRENT L. GRANTHAM
OREGON
07/19/07
LANDSCAPE ARCHITECT
EXP. 07/31/2024

DESIGNER: A VOS
DRAWN BY: A VOS
APPROVED BY: J. GLANDER
DATE: AUGUST 2023
JOB NO: 23-000186
DRAWING FILE NO: 22-000186-X-LS
DRAWING NO: LS-02
SHEET NO: 2 OF 2

NOT FOR CONSTRUCTION