

**CITY OF FLORENCE
RESOLUTION NO. 9, SERIES 2018**

A Resolution Designating the Gateway Plaza Areas of the ReVision Florence Streetscape Project as Special Use Pedestrian Plazas, Open to the Public for Public Purposes.

RECITALS:

1. The City of Florence has been working in partnership with the Florence Urban Renewal Agency and the Oregon Department of Transportation on a streetscape project, commonly referred to as ReVision Florence (Project).
2. The Project area encompasses the Highway 101 corridor from the Siuslaw River Bridge north to the Highway 126 intersection, and the Highway 126 corridor from the Highway 101 intersection east to Spruce Street.
3. The purpose of the Project is to make improvements to Highway 101 and Highway 126 from the Siuslaw River Bridge to Spruce Street. The Project will include repaving, restriping, making sidewalk improvements, adding pedestrian plazas, and constructing related streetscape facilities to improve the safety and visual aesthetics of these major transportation facilities through the heart of the community.
4. As part of the Project, the City of Florence is a party to an Intergovernmental Agreement for Right of Way Services (Agreement No. 31894) with the Florence Urban Renewal Agency and the Oregon Department of Transportation. The City has acquired right of way on behalf of the Florence Urban Renewal Agency to construct the project.
5. The Project includes pedestrian plazas at various locations within the Project area to encourage pedestrian use of Highway 101 and Highway 126, and to provide open spaces along the Highways where citizens and visitors can gather.
6. The gateway plazas are outlined in Exhibit A and will include landscaping, gateway features, public art, and pedestrian amenities.
7. The maintenance of the Project area, including the plazas, has been included in the City's Long Range Financial Plan as a Parks expenditure.

Based on these findings,

THE CITY COUNCIL OF THE CITY OF FLORENCE RESOLVES AS FOLLOWS:

1. The gateway plazas to be constructed as part of the Project, shown in Exhibit A and B, are hereby designated as special use pedestrian plazas, open to the public for public purposes.
2. This Resolution shall become effective upon adoption.

ADOPTION:

This Resolution is passed and adopted on the 21st day of May, 2018.



Joe Henry, Mayor

Attest:



Kelli Weese, City Recorder

EXHIBIT A

ReVision Florence Gateway Plazas

The ReVision Florence gateway plazas to be designated as Special Use Pedestrian Plazas and are found at the corners of the intersections outlined below. The plaza areas correspond with the project map shown to the right, where the colored portions are the project elements that will be constructed during the project.

Highway 126 Gateway Plazas:

1. Quince Street — SW & SE Corners

Highway 101 Gateway Plazas:

2. Maple Street — NE & SE Corners



EXHIBIT B

ReVision Florence Gateway Plazas Detailed Images

1. Quince Street Gateway

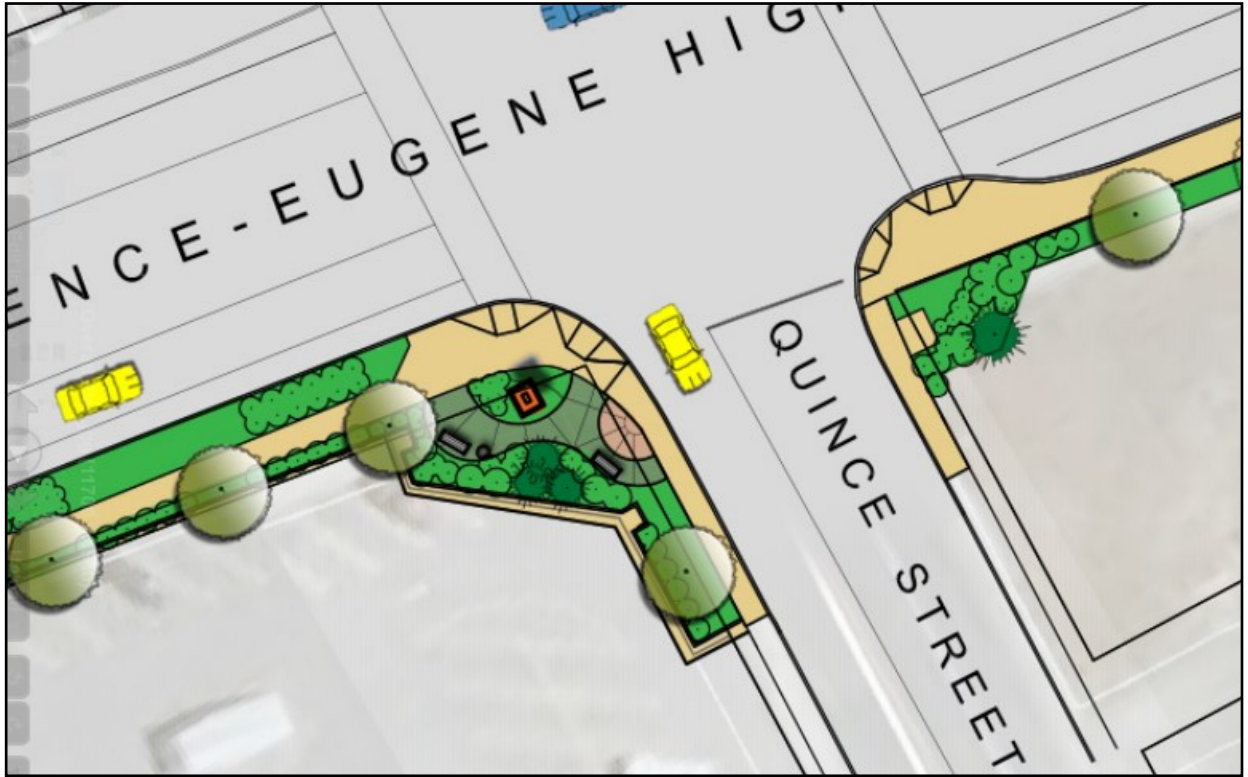

2. Maple Street Gateway

